

The square footages and room size information are deemed to be reliable but are not guaranteed and should be independently verified. This drawing is for marketing purposes only.

# 68 E Sunridge Pl

Presented by Pam Treece  
Long Realty Company  
(520) 275-2664

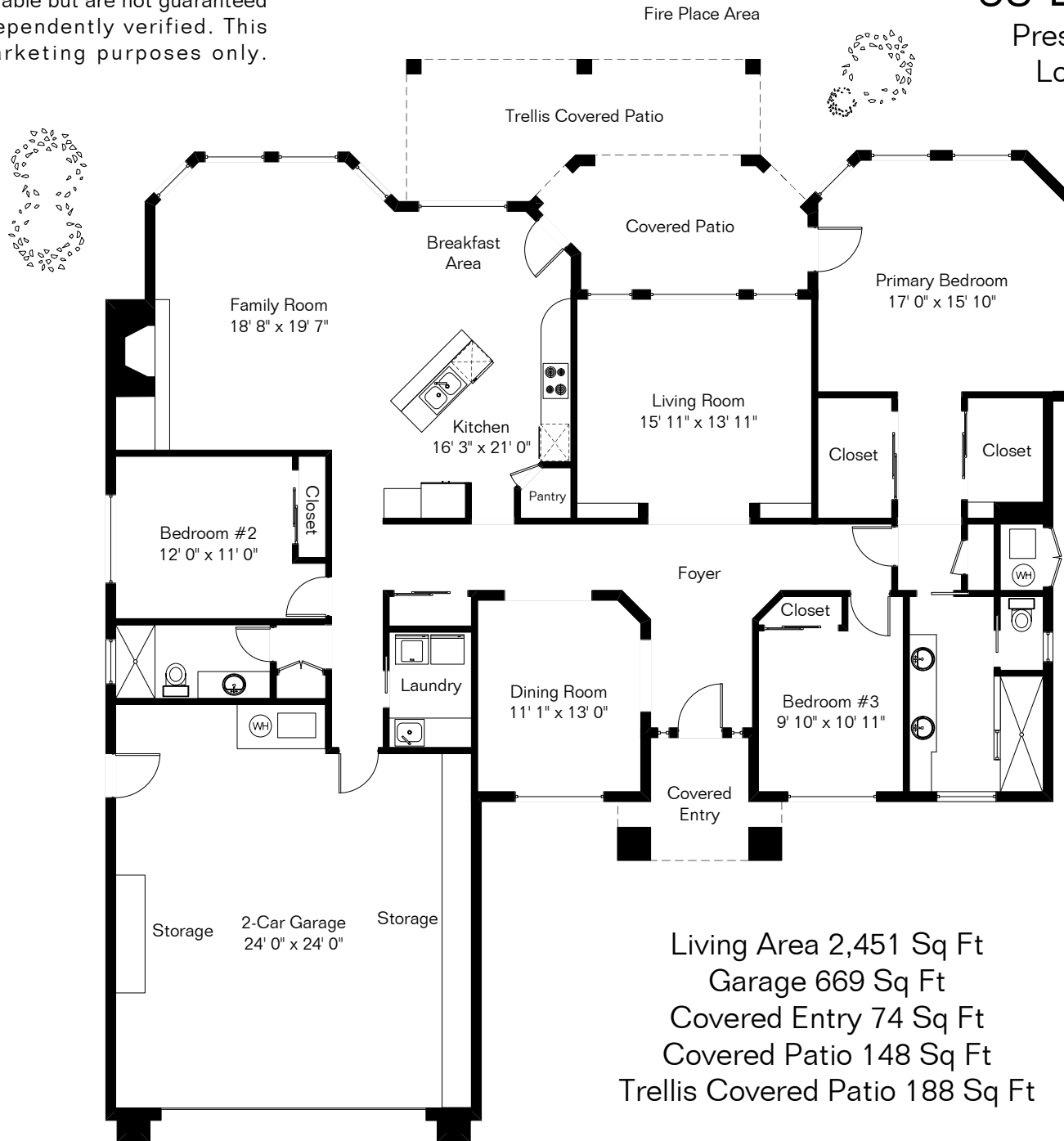

Living Area 2,451 Sq Ft  
Garage 669 Sq Ft  
Covered Entry 74 Sq Ft  
Covered Patio 148 Sq Ft  
Trellis Covered Patio 188 Sq Ft

Site Visit August 2025  
0 ft. 6 ft. 10 ft. 20 ft.  
Copyright 2025 Floor Plans First! LLC  
All Rights Reserved.